

NOMINAL SIZE		SOCKET END (ASTM SCH40)			THREADED END		L	d	A	D	H
		d1	d1'	l	d2	l					
3/8"	13mm	0.687	0.671	0.59	3/8-18 NPT	0.59	2.72	0.59	2.95	1.57	2.07
1/2"	15mm	0.848	0.836	0.69	1/2-14 NPT	0.59	3.11	0.59	2.95	1.57	2.07
3/4"	20mm	1.058	1.046	0.72	3/4-14 NPT	0.67	3.70	0.79	3.43	1.93	2.46
1"	25mm	1.325	1.310	0.87	1- 11-1/2 NPT	0.79	4.25	0.98	3.43	2.28	2.74
1-1/4"	32mm	1.670	1.655	0.94	1 1/4 - 11-1/2	0.87	4.76	1.22	4.13	2.68	3.21
1-1/2"	40mm	1.912	1.894	1.09	1 1/2 - 11-1/2	0.98	5.75	1.57	5.31	3.25	3.78
2"	50mm	2.387	2.369	1.16	2 - 11-1/2	1.10	6.86	2.01	5.31	4.09	4.23

REV	DATE	DESCRIPTION	BY	FROM
A	11/22/16	FIRST ISSUE	CW	MW

NOTE: The shape and appearance of assembly differ a little with nominal size and material compared to this drawing.

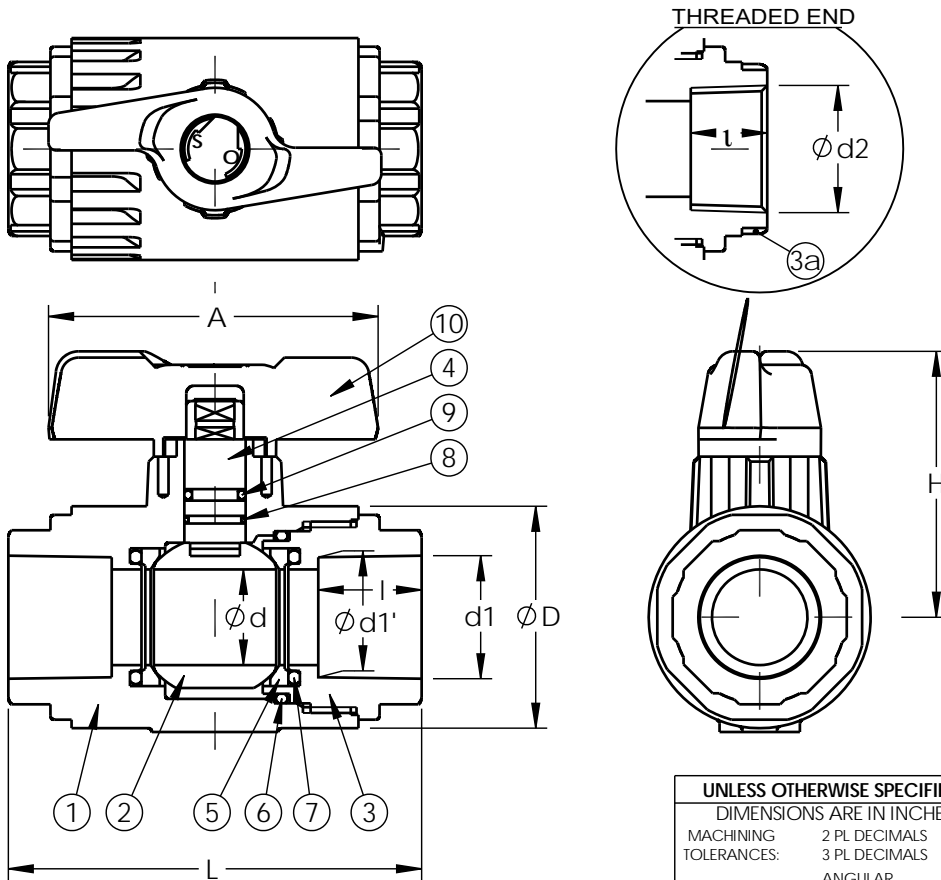

No.	Description	Qty.	Material	Remarks
1	BODY	1		
2	BALL	1	PVC	
3	END CONNECTOR	1	C-PVC	
4	STEM	1		
5	SEAT	2	PTFE	
6	O-RING (B)	1		
7	O-RING (C)	2	EPDM	
8	O-RING (D)	1	FKM	
9	O-RING (E)	1		
10	HANDLE	1	ABS	
3a	RING	2	SS(SUS304)	USED FOR C-PVC BODY THREAD: 3/8"-1"

UNLESS OTHERWISE SPECIFIED	
DIMENSIONS ARE IN INCHES	
MACHINING	2 PL DECIMALS ± .01
TOLERANCES:	3 PL DECIMALS ± .005
	ANGULAR ± 1/2°
	FRACTIONAL ± 1/64
FABRICATION	1/2" - 8" ± 1/4
TOLERANCES:	10" AND UP ± 1/2
	ANGULAR ± 1.0°
WELD TYPE:	N/A
MATERIAL:	AS NOTED
FINISH:	N/A

THIS DRAWING AND ALL INFORMATION HEREIN IS THE PROPERTY OF ASAHI/AMERICA. ANY COPYING, REPRODUCTION OR UNAUTHORIZED USE IS FORBIDDEN WITHOUT WRITTEN CONSENT.	
NAME	DATE
DR C. Williams	11/22/16
REV	
APPR D. Hurley	11/29/16
PRODUCT:	VALVE & ACT
WO#/SO#	

ASAHI/AMERICA
ISO 9001 CERTIFIED
 655 ANDOVER STREET, LAWRENCE, MA



3/8" - 2" OMNI T27 COMPACT BALL VALVE DIMENSIONS

JDE PART # 0062BVT27		SCALE	N/A	SHEET	1	OF	1
SIZE	A	DWG #	0062BVT27	REVISION	A		