



**FS24WJ**

## Electric Spring Return Actuator Standard Features

- Motor: Reversing, brushless, capacitor run 115 VAC 50/60 Hz, single phase
- Overload protection: Integral thermal overload protection for motor windings with automatic
- Gear train: Permanently lubricated
- Conduit: 3/4" FNPT conduit entry
- Enclosure: Type 4X
- Mechanical Brake: Each electric actuator is provided as a standard with a mechanical brake
- Output torque: FS24 electric actuators have an output torque of 300 in/lbs
- PTC Space Heater: A PTC (Positive Temperature Coefficient) space heater is provided as standard equipment
- Springs constructed of oil tempered spring steel with Xylan coating

## Options

- Feedback potentiometer
- Additional (Auxiliary) limit switches
- Type 7 enclosure
- Local Remote Station

## Engineering Data

ENGINEERING DATA					
Model	Torque (in/lbs)	AMP Draw	Duty Cycle	Cycle Time per 90 degrees of travel (seconds)	Weight (lbs)
FS24	300	1.05	25%	10 Electrical/ 2 springs	23

## Specifications

**Size:** FS24  
**Torque:** 300 in/lbs  
**Voltage:** 115 VAC 1 Ph 50/60Hz  
**AMP Draw:** 1.05  
**Conduit Entry:** 3.4" FNPT  
**Max Ambient Temp:** 150° F  
**Switches:** Two (2) single pole, double throw (2-SPDT) 15 amp rated  
**Cycle Time per 90°:** 10 sec. electrically driven  
 2 sec. spring driven

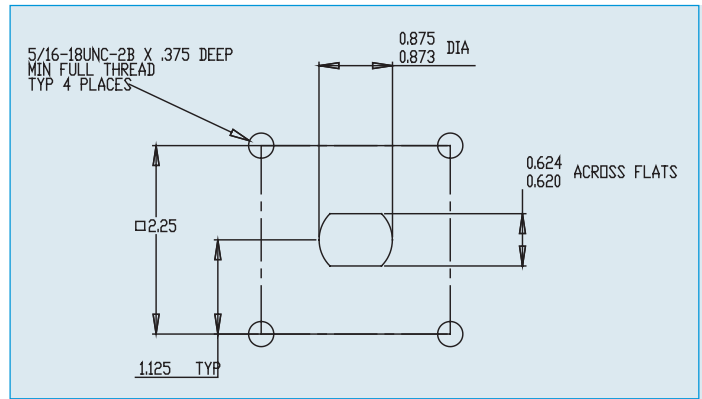

## Sample Specification

