

Ball Valves

- Compact design for easy integration
- Proven reliability through years of use
- Wide range of materials and configurations
- One-piece ball & stem eliminates leakage



Mounting Options

Panel mounting:

The ball valves can be supplied with a male thread on top and a loose hexagon nut for panel mounting. Max panel thickness 7mm.

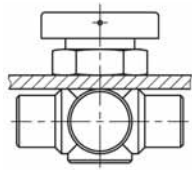

Mounting bracket:

Mounting brackets can be used for vertical or horizontal mounting.

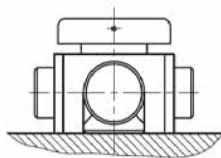

Fastening clips:

Fastening clips are only used for wall mounting. They are straightforward to use and quick to fit.

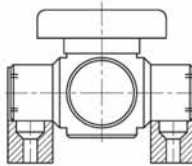

Sample Flow Patterns

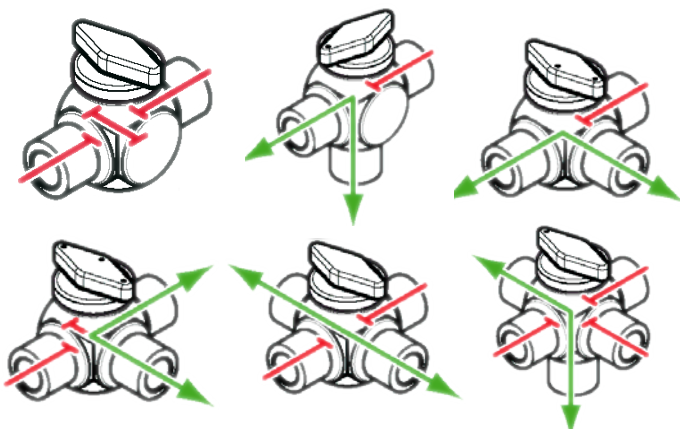

Specifications

Connections: 1/4" -1/2" NPT or G

Pressure Rating:

	PP	PVDF	PFA
Temperature (°F)	194	248	356
Pressure (psi)	150	150	150

Materials:

Housing	PP	PVDF	PFA
Ball	PP	PVDF	PTFE
Sealing sleeve	PTFE	PTFE	PTFE
Pressure screw	PP	PVDF	PTFE
O-ring	FKM	FKM	FKM

Cv Value:

Valve	DN 04	DN 08
2-Way	0.71	2.20
3-Way Vertical	0.67	1.86
3-Way Horizontal L Bore	0.67	1.86
3-Way Horizontal T Bore	0.67	1.86
4-Way Through Bore	0.71	1.86
4-Way Double L Bore	0.52	N/A
5-Way L Bore	0.67	N/A

Pneumatic



Max. perm. ambient (°F)	140
Volume (nanoliters)	0.5
Control pressure (psi)	45-90
Torque (in-lbs)	25-50
Connecting thread	G 1/4"

Electric



Max. perm. ambient (°F)	160
Voltage (VDC)	24
Torque (in-lbs)	45-90
IP Rating	IP 65
Connection	PG 9

Compact Pneumatic



Max. perm. ambient (°F)	160
Voltage (VDC)	24
Power Consumption (mA)	180
Torque (in-lbs)	50
EN 60529 Protection	IP 65
Connection	PG7

Position Indicators



Max. permanent Ambient (°F)	140	Max. perm. ambient temp.: 50°C	120
Function	PNP	Duty cycle	100%
Voltage (VDC)	10-30	Operating pressure (psi)	150
Rating (mA)	200	Power consumption (VA)	6.5
EN 60529 Protection	IP 65	EN 60529 protection	IP 65
		Voltage (VDC)	24
		Connecting thread	G 1/4"

Mega Multiport Ball Valve

Asahi/America leads the market with custom capabilities. These 7 to 11 port ball valves are an excellent choice for manual or automated flow diversions.

To learn, please contact your local Asahi representative at (800)-343-3618 or visit us online at www.asahi-america.com

